



www.cbefactory.it

info@cbefactory.it



Shift shaft holder & sprocket cover – Assembly
instructions

SCPAP001B04

Aprilia RSV4 all m.y.

Aprilia Tuono V4 all m.y.

SCPAP001B04 – Shift shaft holder & sprocket cover – Assembly instructions.

Tools required:

male hexagonal head screwdriver, 5 mm.

Female hex head screwdriver, 8 mm, 12mm.

According to OEM service manual remove lower fairing.

1. Remove the following 4 OEM screws with 8 mm wrench:

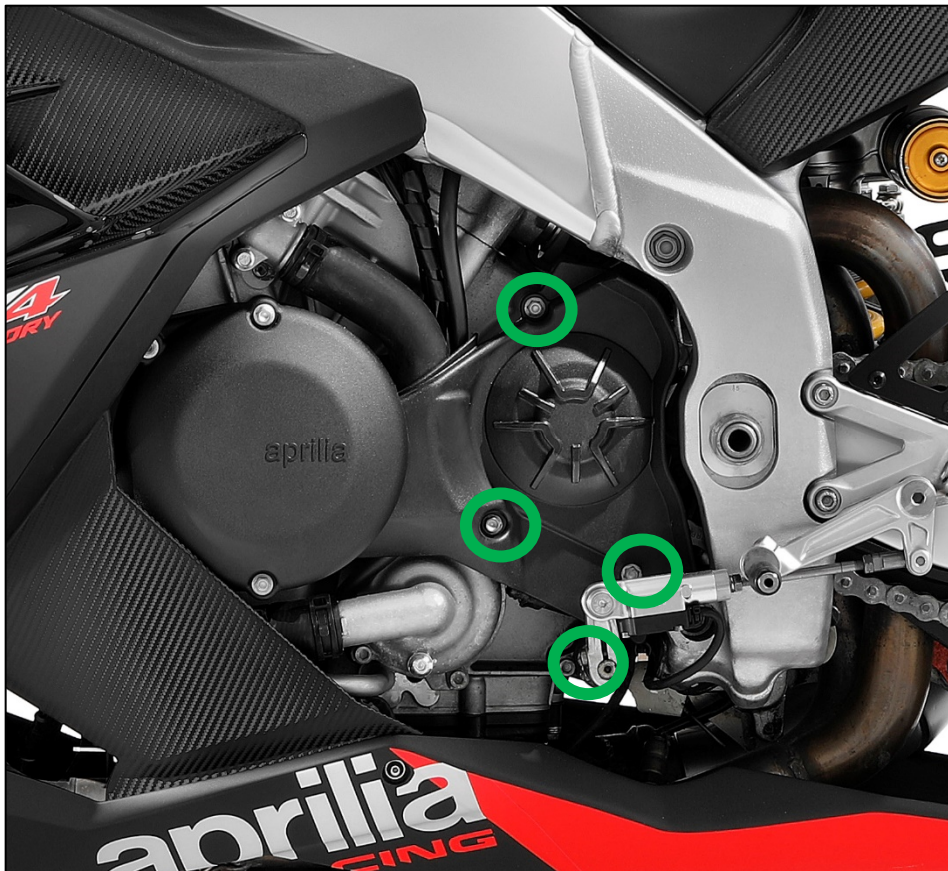

2. Remove the plastic cover; apply a mark between shift leverage and shaft and disassemble leverage:



3. Remove the following 2 OEM threaded bushes with 12 mm wrench:

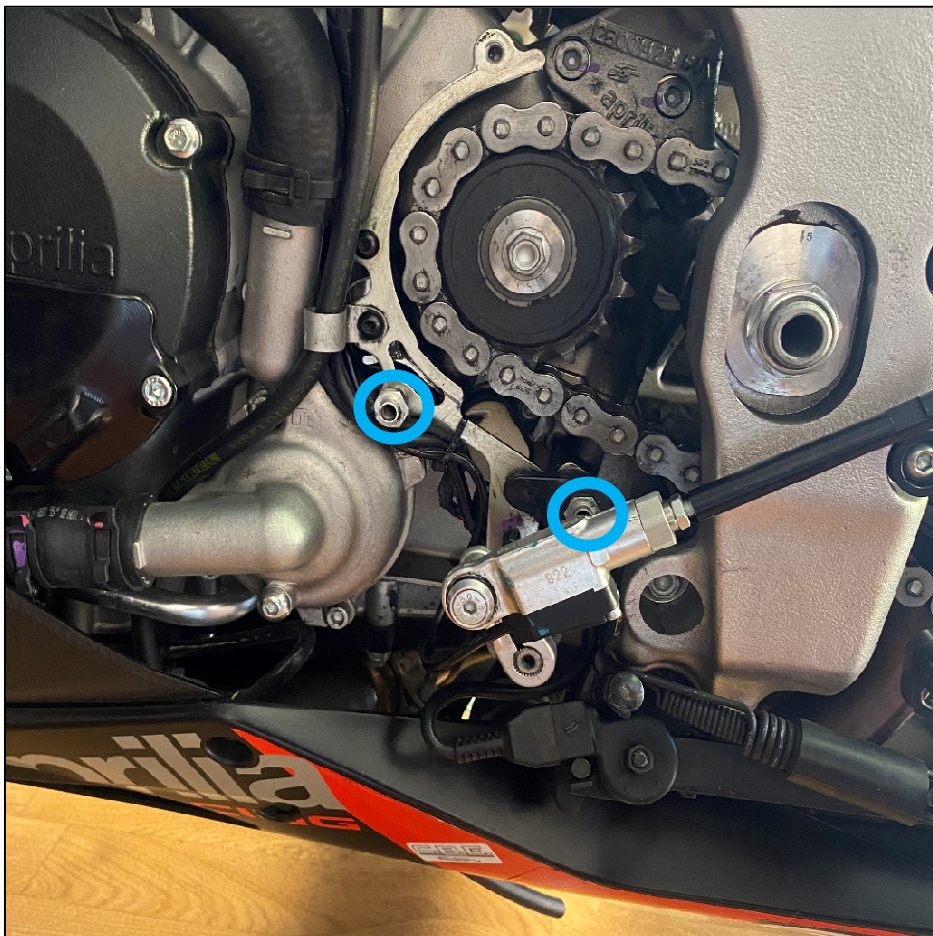

4. If your bike has the OEM part number 7 (chain slider), install bush #3:

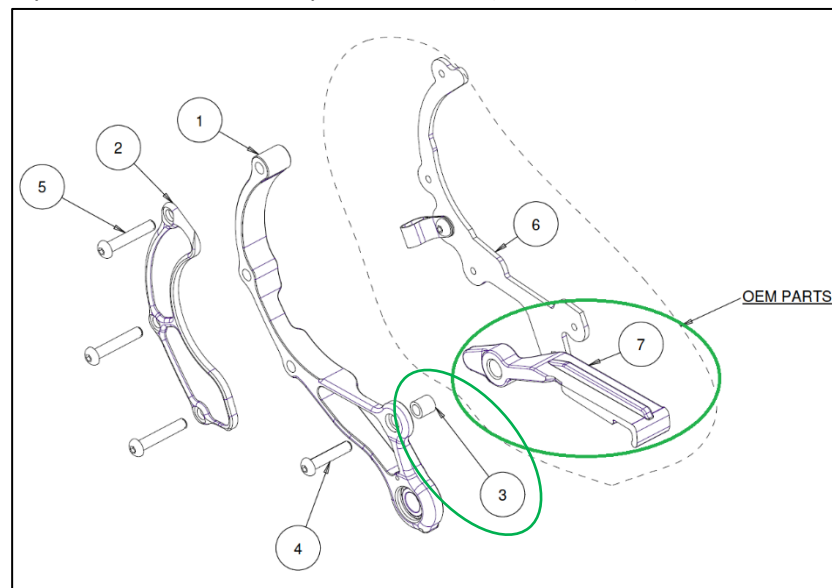

Otherwise, install the bush #3.1:

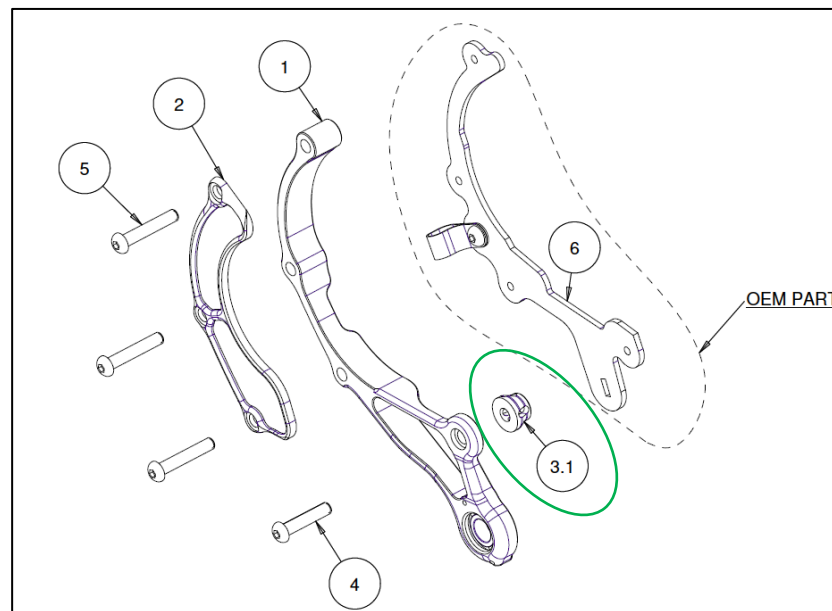

5. Example with part 7 present:

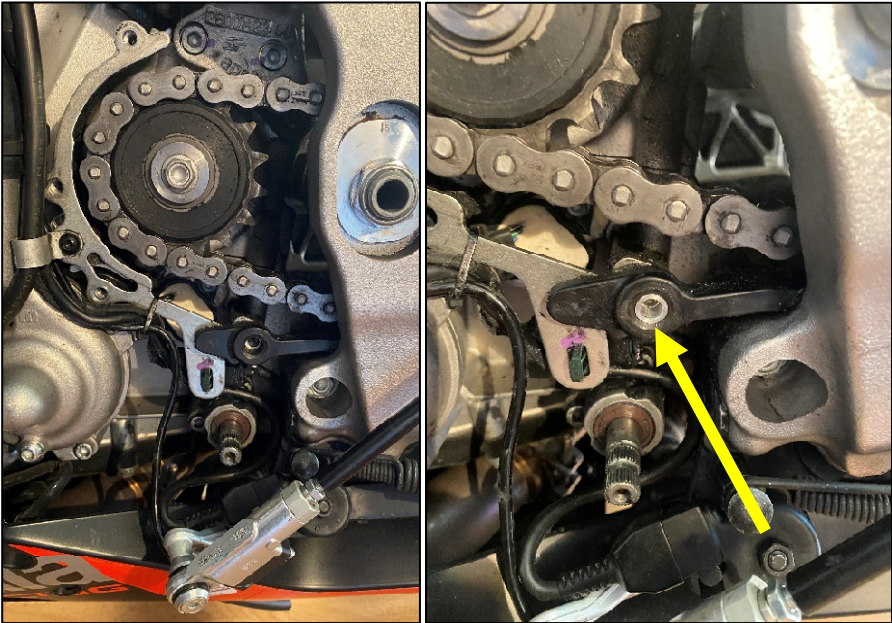

6. Assembly shift shaft support and sprocket cover, using the following screws length:

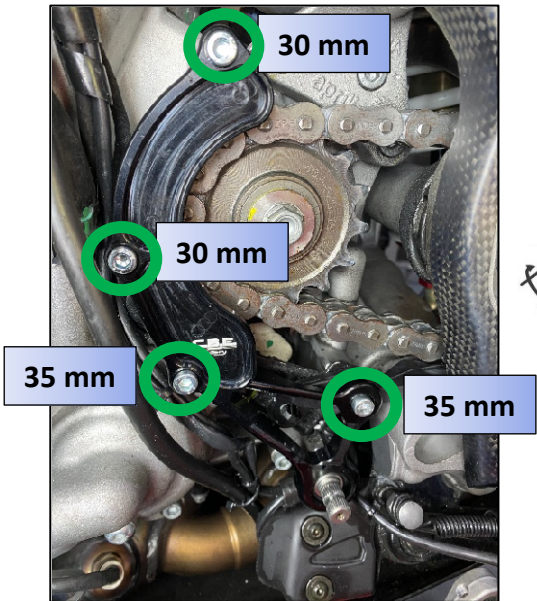

7. Assembly shaft leverage:

