

1 1.1 Disassembly rear wheel, OEM regulation system and screws.

1.2 Remove plastic pins on swingarm

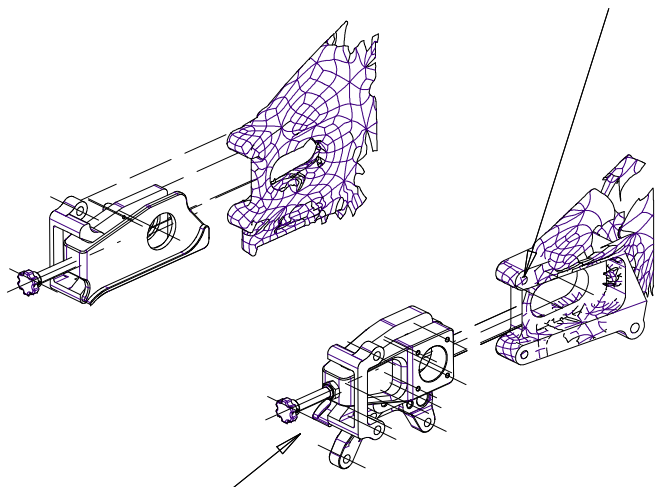

1.3 Install regulations system preassembled.

Tightening torque: 9 Nm

2

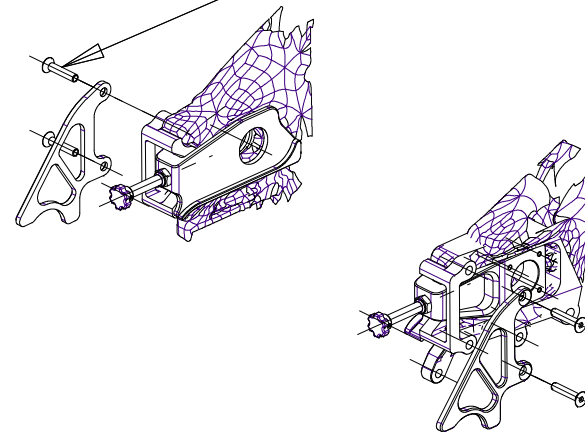

Install stand supports RH and LH.

4

4.1 Install bushes on rear wheel.
4.2 install rear wheel and axle.

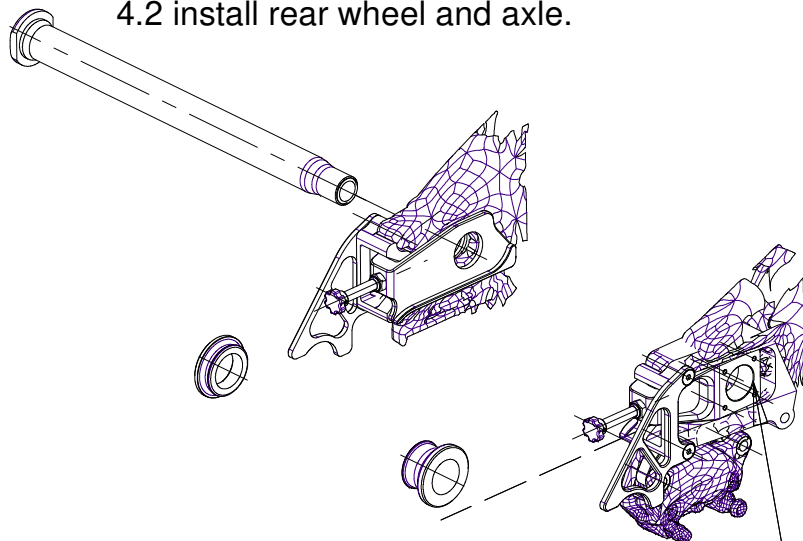

Tightening torque: 120 Nm

Install OEM Brembo brake caliper and ABS sensor using original screws.
Caliper screw torque: 29 Nm.
Abs screw torque: 9 Nm.

3

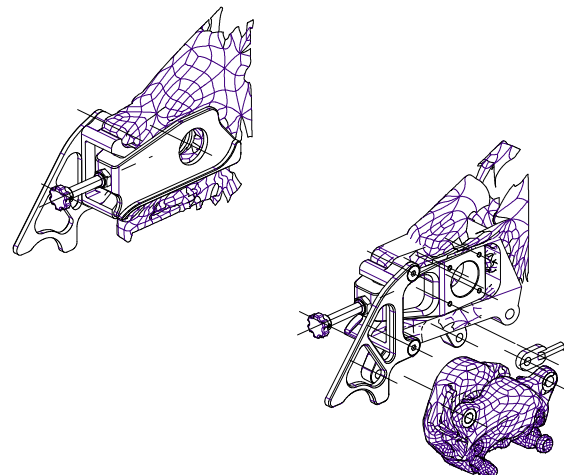

Rear wheel quick change system
Assembly instruction

C.B.F.
factory

REV. 00 | DWG. No. QCSHO001B01

Standard color: BLACK

